

## 1

### Hardware Installation

1. Connect to your local area network: connect a Ethernet cable to the Ethernet port of the wireless Portable Router, and the other end to a notebook or PC.
2. Power on the device: Connect the included AC power adapter to the wireless Portable Router power port and the other end to a wall outlet.

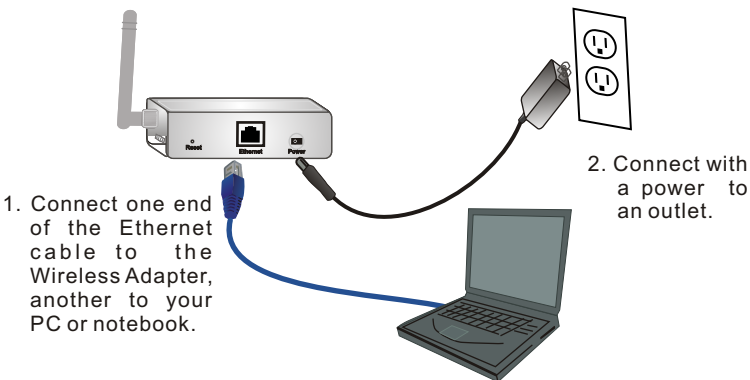

No password is required by default, simply enter the User name 'admin', which is fixed and cannot be changed, and then click OK.



Enter the fixed User name here

### Wireless Modes

Select a wireless mode, and then click the Setup button to enter its configuration screen.

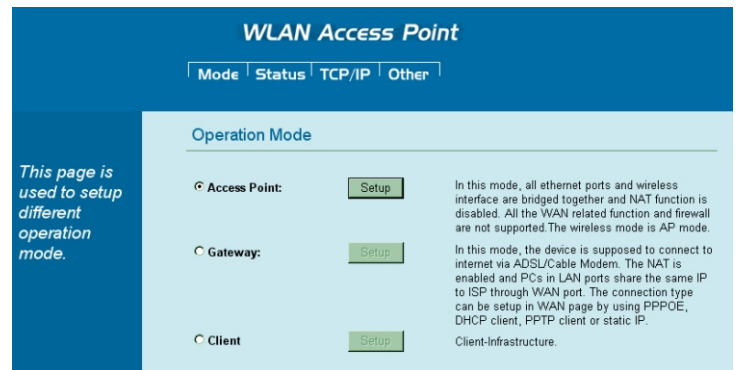

### Check the LED Indicators

	LED indicator	Color	Status	
			Solid	Flashing
1	Power	Blue	Turns solid Blue when the power is applied to this device.	NA
2	Ethernet	Blue	Turns solid Blue when an Ethernet cable is connected.	Receiving/Sending data
3	Wireless	Blue	Turns solid Blue when the wireless is applied to this device.	Receiving/Sending data

## 2

### Access Point Configuration

1. Start your computer. Connect an Ethernet cable between your computer and the wireless Portable Router.
2. Make sure your wired station is set to the same subnet as the wireless Portable Router, e.g., 192.168.1.254
3. Start your WEB browser. In the Address box, enter the following: HTTP://192.168.1.254

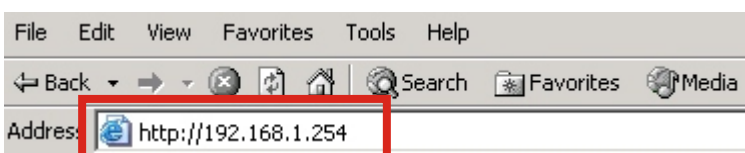

The wireless connection applications for each mode.

